

MUNCK

Strømtilførsel





MUNCK

**INSULATED CONDUCTOR RAIL
FOR ELECTRICAL FEEDING OF CRANES**

munck



– all about handling

MUNCK 70-100-140-200 A

Components

A white line graphic that starts on the left, rises slightly, then drops vertically and continues horizontally to the right.

Line type C: continuous conductors - Line type P: pre-mounted conductors

17 Expansion jointCODE: **03.54415.00**

Used in particularly long lines to compensate the expansion of the insulating housing. Installed between 2 fixed points. It is necessary to foresee a further support bracket.

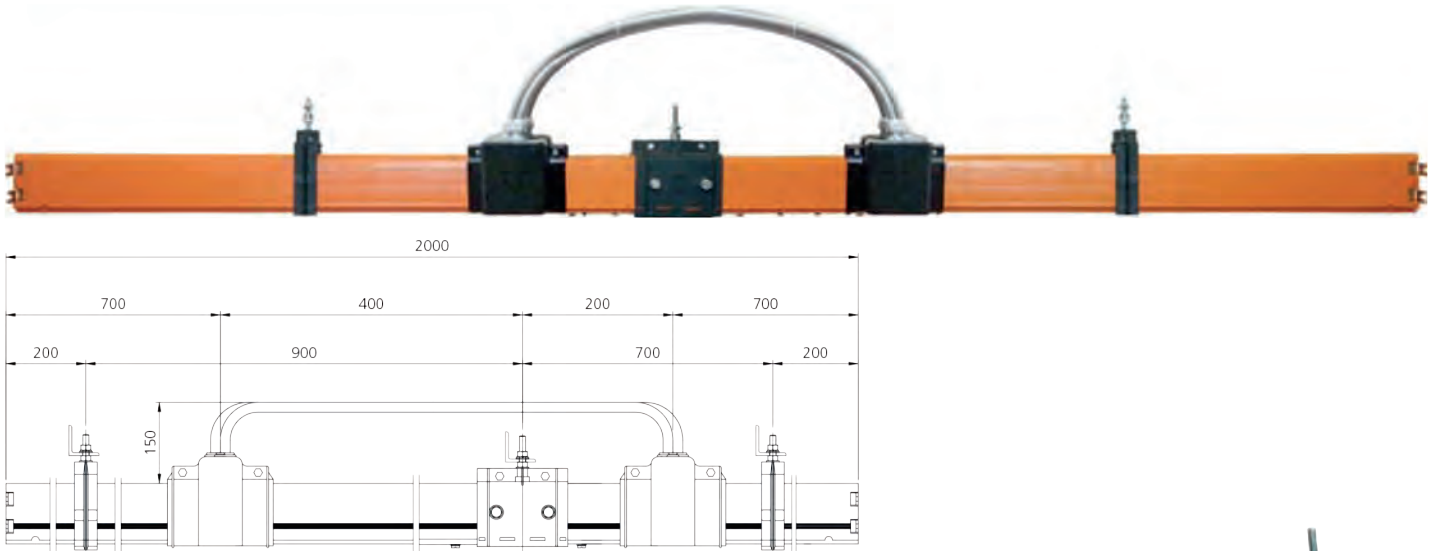
FEATURES:**Line Type P****18** Inspection point**FEATURES:****Line Type C**CODE: **03.03022.90**

It consists in a removable section of insulating housing, that allows the inspection and the eventual extraction of the collector trolley. For the installation, it's necessary to foresee 2 further support brackets.

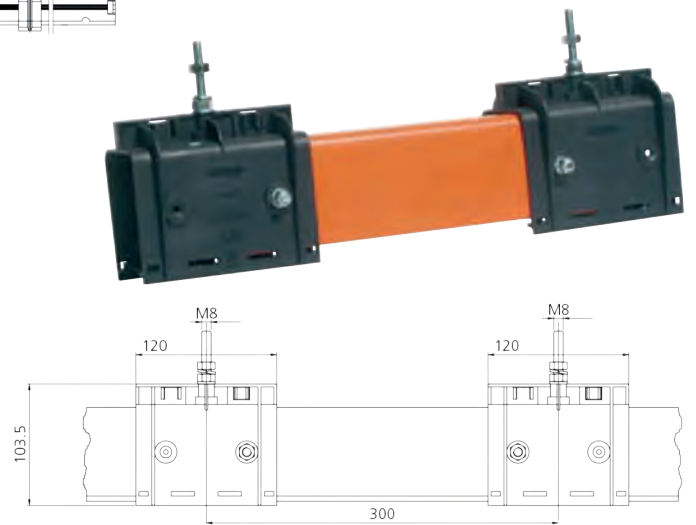
**19** Sectionalizing joint**FEATURES:****Line Type C/P**CODE: **03.03021.90**

It allows to divide electrically the line in various insulated sections, in order to create insulated maintenance areas.

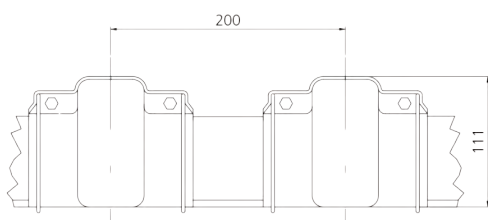

20 Transfer guide for collector trolley

FEATURES: Line Type **C/P**

CODE: **03.08031.90NH5P**

It serves to facilitate the insertion of the current collector in case of interrupted line.

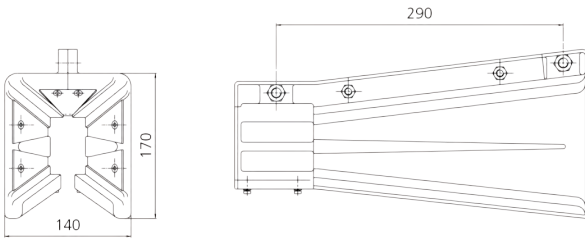

21 Alignment plates

FEATURES: Line Type **C/P**

CODE: **5.090301.06**

Inserted in the side grooves of the housing, they ensure a perfect alignment nearby the junctions and an optimization of the current collector sliding.



CURRENT COLLECTOR TROLLEYS

22 Current collector trolley with contact shoes 35 A

FEATURES: Line Type **C**

The body is completely insulated and the contact shoes are made of metal carbon. Equipped with 5 m. cable and towing arm attachment (the towing arm code 03.08026.91 is not included).

Inside there is a terminal box, that can be easily reached for any eventual maintenance, without removing the current collector from the insulating housing.

In case of Amperage more than 35 A, a parallel connection with 2 or more collectors is necessary or, as alternative, a current collector trolley for higher amperages can be used as per the following table:

CODE	AMPERAGE (A)	CONTACT SHOES N°
03.08024.92NC	35 A	4
03.08024.93NC		5

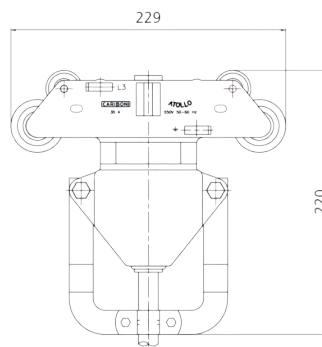

23 Current collector trolley with contact shoes 35 A

FEATURES: Line Type P

Contact shoes are made of metal carbon; equipped with 5 m. cable, towing arm attachment (cod. 03.04019.90) and towing arm (cod. 03.08026.90) not included.

CODE	AMPERAGE (A)	CONTACT SHOES N°
03.08024.92C5	35 A	4
03.08024.93C5		5

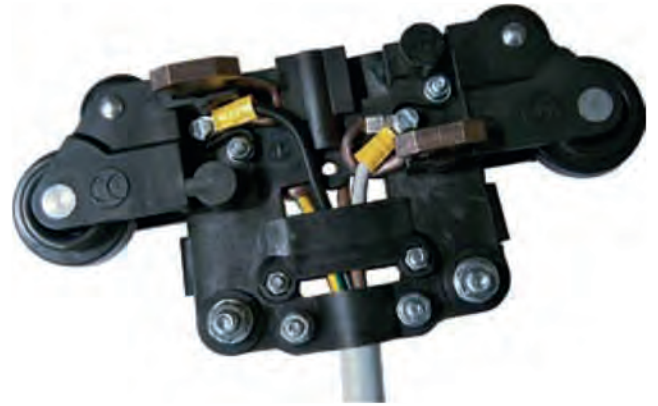
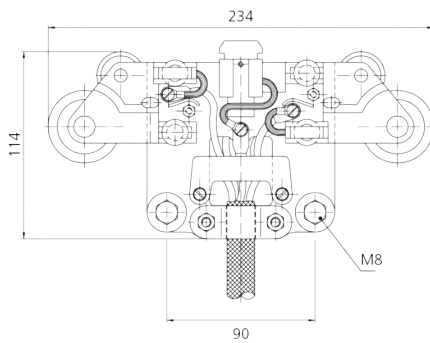

24 Current collector trolley with contact shoes 70 A

FEATURES: Line Type C/P

The body is completely insulated and the contact shoes are made of metal carbon. Equipped with 5 m. cable (the towing arm code 03.08026.91 and towing arm attachment code 03.08025.91 are not included). In case of higher Amperage than 70 A, 2 or more current collectors must be connected together.

CODE	AMPERAGE (A)	CONTACT SHOES N°
03.08034.92C5	70 A	4
03.08034.93C5		5

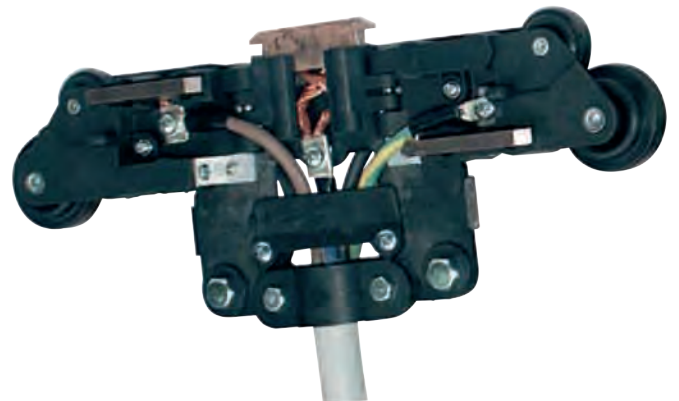
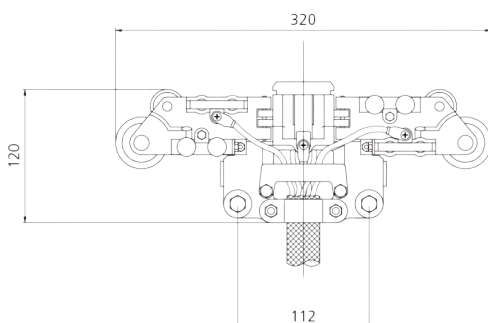

Line type C: continuous conductors - Line type P: pre-mounted conductors

25 Double current collector trolley with contact shoes, complete with coupling device - total amperage 70 A (2x35 A)

FEATURES: Line Type C

It is composed by 2 current collectors 35 A, connected through a coupling device.

CODE	AMPERAGE (A)	CONTACT SHOES N°
03.08027.94N	2x35 A	4
03.08027.95N		5

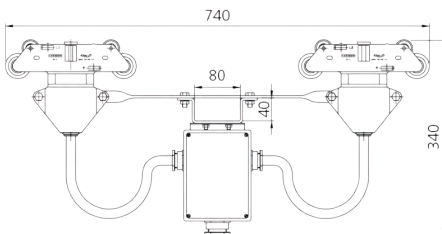

26 Double current collector trolley with contact shoes, complete with coupling device - total amperage 70 A (2x35 A)

FEATURES: Line Type P

It is composed by 2 current collectors 35 A, connected through a coupling device (towing arm cod. 03.08028.90 is not included).

CODE	AMPERAGE (A)	CONTACT SHOES N°
03.08027.94	2x35 A	4
03.08027.95		5

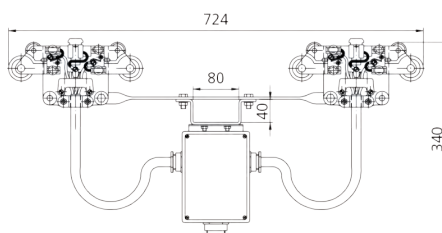

27 Double current collector trolley with contact shoes, complete with coupling device - total amperage 140 A (2x70 A)

FEATURES: Line Type **C/P**

It is composed by 2 current collectors 70 A, connected through a coupling device (towing arm cod. 03.08028.90 is not included).

CODE	AMPERAGE (A)	CONTACT SHOES N°
03.08041.94	2x70 A	4
03.08041.95		5

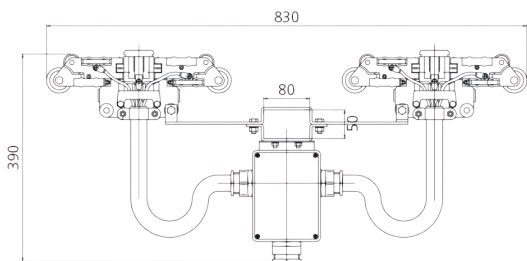

28 Current collector trolley for curves with 4 contact shoes 35 A

FEATURES: Line Type **C/P**

CODE: **03.08024.97C**

The body is completely insulated and the contact shoes are made of metal carbon. Equipped with 2 m. cable (the towing arm code 03.08026.90 and the towing arm attachment code 03.04019.90 are not included).

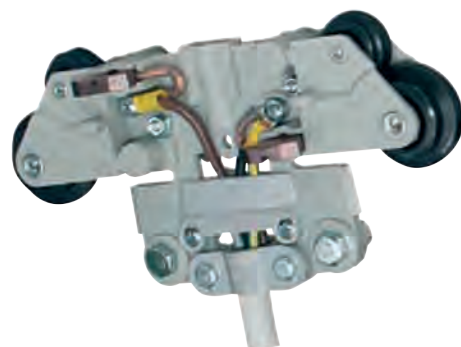
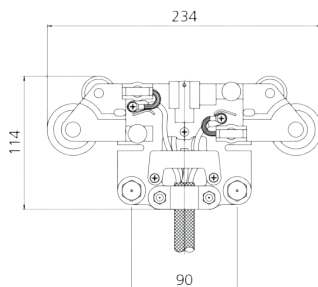

29 Towing arm attachment

FEATURES: Line Type **C/P**

Fixed to the trolley, it allows the coupling with the towing arm.

FOR TROLLEY CODE	"A"	CODE
03.08024.97C for curves 03.08024.92C5 - 93C5	90 mm.	03.04019.90
03.08024.92NC - 93NC	112 mm.	03.04019.91
03.08034.92C5 - 93C5	112 mm.	03.08025.91
03.08027.94 - 95	90 mm.	03.04019.90

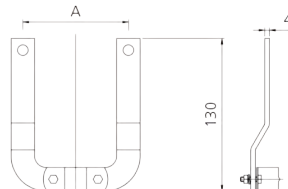

Line type C: continuous conductors - Line type P: pre-mounted conductors

30 Towing arm**FEATURES:**Line Type **C/P**

Fixed to the mobile machine it serves to tow the current collector trolley.

FOR TROLLEY CODE	"A"	CODE
03.08024.97C for curves 03.08024.92C5 - 93c5	140 mm.	03.08026.90
03.08024.92NC - 93NC	160 mm.	03.08026.91
03.08034.92C5 - 93C5	160 mm.	03.08026.91
03.08027.94N - 95N / 03.08027.94 - 95 / 03.0804194 - 95	70 mm.	03.08028.90

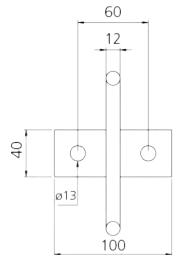
**31** Current collector suspension device for transfer guide**FEATURES:**Line Type **C/P**

CODE: **03.08020.90**

It serves to support the collector trolley and to facilitate its introduction into lines with transfer guide code 03.08031.90N.

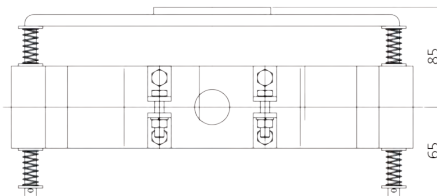
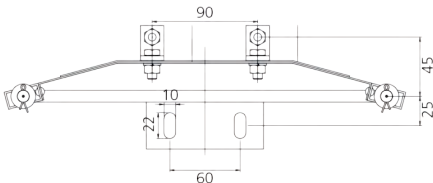
**MOUNTING TOOLS****32** Roll holder plate**FEATURES:**Line Type **C**

CODE: **03.08033.90**

Held on a support positioned at the same level of the contact line, it facilitates the unwinding of the conductor from the roll and the introduction into the insulating housing. Extremely light and easy to use.

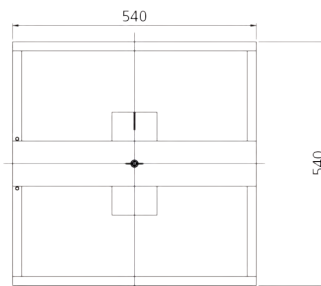

33 Trolley for the insertion of the conductor

FEATURES: Line Type **C**

CODE: **03.08030.90N**

Through a tension wire it serves to slide easily the conductor into the insulating housing.

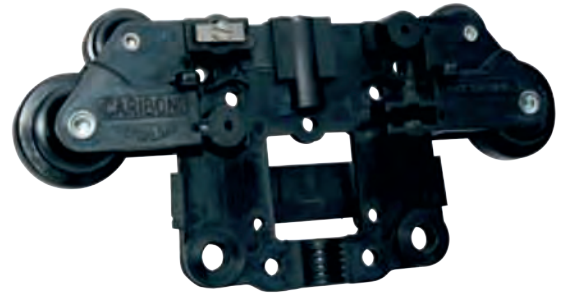
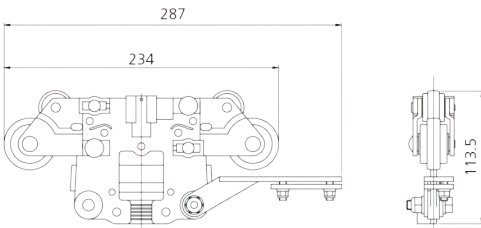

34 Trolley for the insertion of the simple strip for closure

FEATURES: Line Type **C/P**

CODE: **03.08008.90N**

Through a tension wire it serves to slide easily the simple strip for closure into the proper shaped seat places in the side lower of the insulating housing.

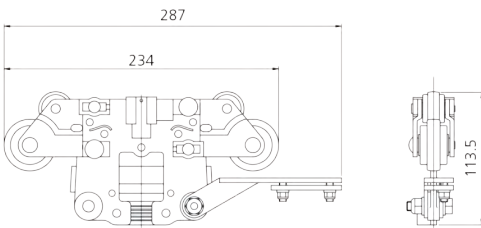

35 SUPPORT BRACKETS

FEATURES: Line Type **C/P**

Necessary to support the insulated feeding line it can be fixed to the track rail (type 1) or to the wall (type 2).

TYPE	"A"	CODE
1	350 mm.	03.08051.90
	500 mm.	03.08051.91
	700 mm.	03.08051.92
2	350 mm.	03.08052.90
	500 mm.	03.08052.91

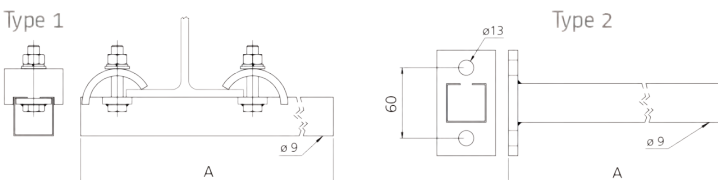

Line type C: continuous conductors - Line type P: pre-mounted conductors

SPARE PARTS

36 Contact conductor

Line Type C

CODE	AMPERAGE (A)
03.08009.90	70
03.08010.90	100
03.08011.90	140

37 Insulating housing

Line Type C

CODE	LENGTH
03.03006.90	4 mt.
03.03006.91	2 mt.

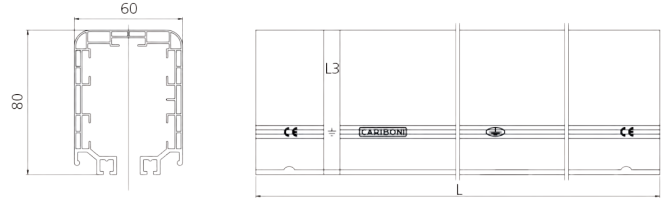

38 Contact shoes

Line Type C/P

FOR TROLLEY CODE	AMPERAGE (A)	CODE
03.08024.97C for curves 03.08024.92C5 - 93C5 for type P 03.08027.94 - 95 for type P	35	03.08036.90S
03.08024.92NC - 93NC for type C 03.08027.94N - 95N for type C	35	03.08056.90
03.08034.92C5 - 93C5 for type C e P 03.08041.94 - 95 for type C e P	70	03.08036.91

Example of a possible installation

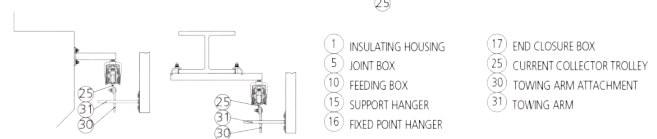
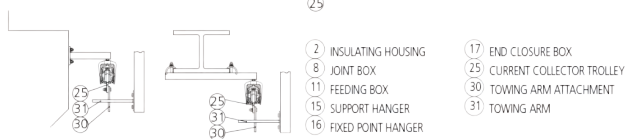
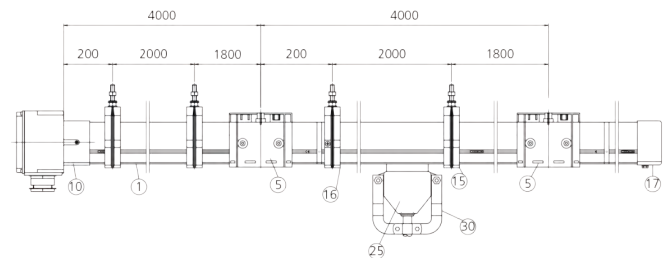
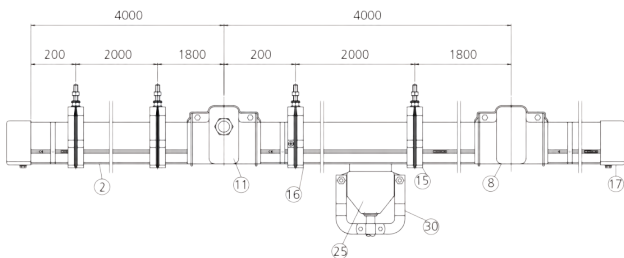



– all about handling

MUNCK 40-60 A

Components

LINE TYPE C: CONTINUOUS CONDUCTORS

FEATURES:

The contact conductors, cut according to the requested length, are inserted inside the housing as soon as it has been installed.

In this way an electrical line with continuous conductors has been realised with a considerable reduction of mounting time. This version guarantees also a minimum voltage drop as well as a reduced wear and tear of contact shoes. Inside the housing, a nib has been foreseen in order to avoid the wrong insertion of the trolley.



Line Type C: INSULATED HOUSING WITH CONTINUOUS CONDUCTORS			
L (m)	Conductors N°	Code	
		40 A	60 A
4	4	03.04044.90	03.04044.91
	5	03.04045.90	03.04045.91
2	4	03.04024.90	03.04024.91
	5	03.04025.90	03.04025.91

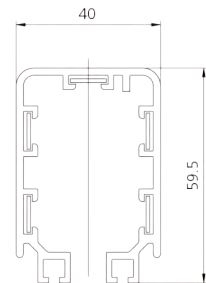

LINE TYPE P: PRE-MOUNTED CONDUCTORS

FEATURES:

The conductors are already inserted in the housing, inside the relevant seats. In order to facilitate the insertion, the extremities of the conductors have been bent and are ready for the joint with the relevant clamps.

Inside the housing, a nib has been foreseen in order to avoid the wrong insertion of the trolley.



Line Type P: PRE-MOUNTED CONDUCTORS			
L (m)	Conductors N°	Code	
		40 A	60 A
4	4	03.04244.90	03.04244.91
	5	03.04245.90	03.04245.91
2	4	03.04224.90	03.04224.91
	5	03.04225.90	03.04225.91

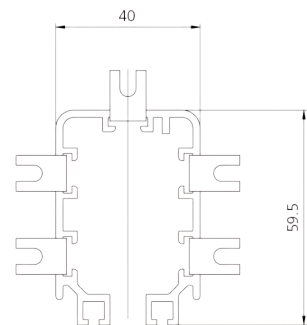

Line type C: continuous conductors - Line type P: pre-mounted conductors

All plastic components are made by insulating and self-extinguishing material.

39 Joint box for housing

FEATURES:

Line Type C

CODE: **03.04003.90**

It serves to connect two sections of the insulated housing. The release application is very easy and can be carried out without screws and it's equipped with 2 nibs, which guarantee a safe fixing on the housing.

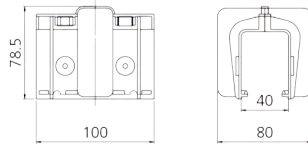

40 Joint box for fixed point

FEATURES:

Line Type C

CODE: **03.04004.90**

It serves to connect two sections of insulating housing. Fixed to the support bracket to ensure an even distribution of the expansion.

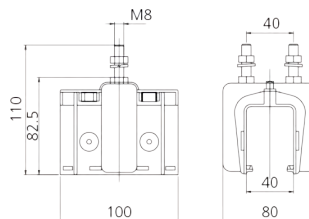

41 Joint clamp

FEATURES:

Line Type C

CODE: **03.04015.90**

Used for the connection of conductors in case of extension of existing lines or of lines particularly long, where the conductor cannot be inserted in one operation.

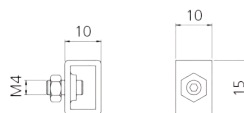

42 Joint box for housing

FEATURES:

Line Type P

CODE: **03.04005.90**

It serves to connect two sections of the insulating housing in case of line type P (pre-mounted conductors).

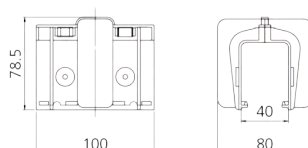

Line type C: continuous conductors - Line type P: pre-mounted conductors

43 Joint clamp

FEATURES: Line Type **P**

CODE: **03.04016.90**

It serves to join the contact conductors in case of line type P (pre-mounted conductors). It is inserted in the copper, which has already been prepared for the assembling.

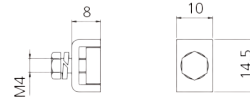

44 End feeder box

FEATURES: Line Type **C**

CODE: **03.04007.90**

It is mounted at the end of the line. The removal of the back cover allows an easier installation.

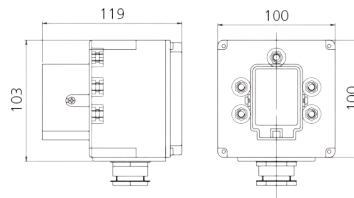

45 Line feeder box

FEATURES: Line Type **C/P**

CODE: **03.04006.90**

It can be mounted on each point of the line nearby the junction of 2 housing sections.

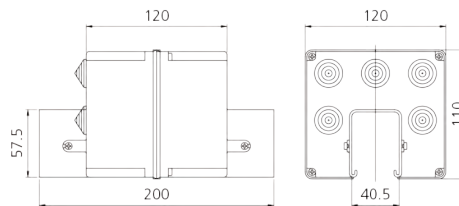

46 Terminal connector for feeder cable

FEATURES: Line Type **C/P**

CODE: **8.14.00.0037-8.14.00.0038**

Inserted in the joint clamp, it serves to connect the cable to the conductor, inside the line feeder box.

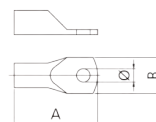

CODE	AMPERAGE (A)	DIMENSIONS mm.			MAX. CABLE SECTION (mm ²)
		A	B	Ø	
8.14.00.0037	40	23	10	4,25	6
8.14.00.0038	60	26	10	4,25	10

Line type C: continuous conductors - Line type P: pre-mounted conductors

47 Support hanger**FEATURES:****Line Type C/P**CODE: **03.04008.90**

It permits the creep of the insulating housing due to expansion. The installation distance between two support hangers must be max. 1,33m.

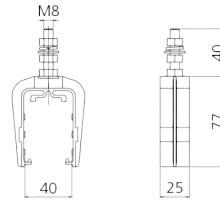
**48** Fixed point hanger**FEATURES:****Line Type C/P**CODE: **03.04009.90**

Locked to the housing with two lateral screws, it serves to obtain a fixed point so to ensure an even distribution of the expansion.

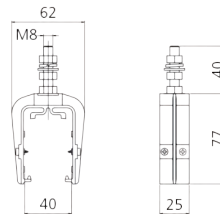
**49** End closure box**FEATURES:****Line Type C/P**CODE: **03.04010.90**

It serves to close the end of the line and is fixed to the insulating housing.

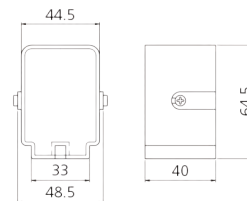
**50** Simple strip for closure**FEATURES:****Line Type C/P**CODE: **03.04011.91**

Two flexible sealing strips, passed through the side grooves of the housing, will give an additional protection of the contact line from IP 13 to IP 23.



Line type C: continuous conductors - Line type P: pre-mounted conductors

51 Inspection point

FEATURES: Line Type **C**

CODE: **03.04020.90**

It consists in a removable housing section, which allows the inspection and the eventual removal of the collector trolley. For the mounting 2 further support brackets must be foreseen.

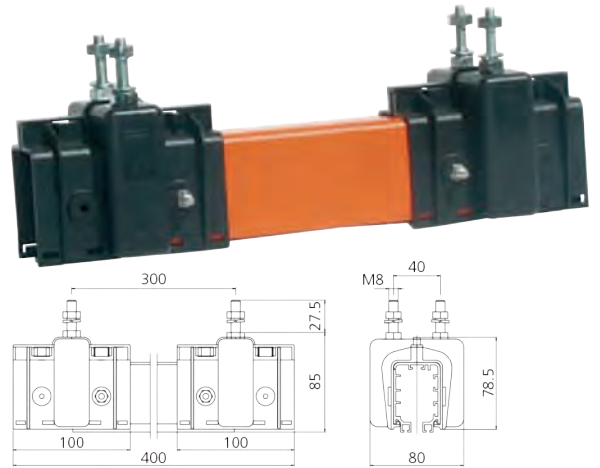

52 Sectionalizing joint

FEATURES: Line Type **C/P**

CODE: **03.04013.90**

It permits to divide electrically the line in various sections, in order to create insulated maintenance areas.

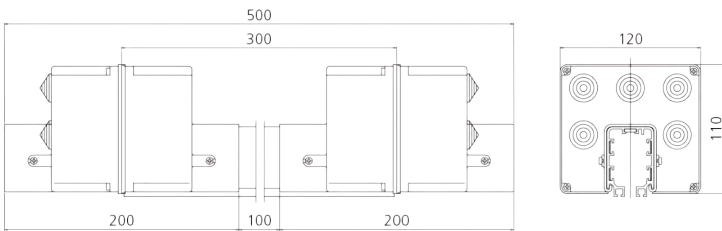

53 Transfer guide for collector trolley

FEATURES: Line Type **C/P**

CODE: **03.04027.90**

It serves to facilitate the insertion of the current collector in case of interrupted line.

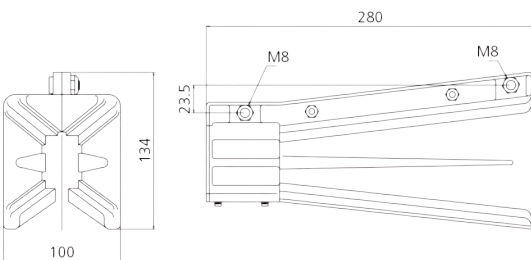

54 Alignment plates

FEATURES: Line Type **C/P**

CODE: **5.090301.08**

Inserted in the side grooves of the housing, they ensure a perfect alignment nearby the junctions and an optimization of the current collector sliding.



Line type C: continuous conductors - Line type P: pre-mounted conductors

55 Current collector trolley with contact shoes 25 A**FEATURES:** Line Type C/P

The body is completely insulated and the contact shoes are made of metal carbon. Equipped with 5 m. cable and towing arm attachment (the towing arm code 03.08026.90 is not included). Inside there is a terminal box, that can be easily reached for any eventual maintenance, without removing the current collector from the insulating housing. In case of Amperage more than 25 A, a parallel connection with 2 or more collectors is necessary or, as alternative, a current collector trolley for higher amperages can be used as per the following table:

CODE	AMPERAGE (A)	CONTACT SHOES N°
03.04018.94C	25 A	4
03.04018.95C		5

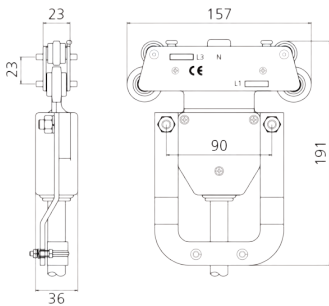
**56** Double current collector trolley with contact shoes, complete with coupling device - total amperage 50 A (2x25 A)**FEATURES:** Line Type C/P

It is composed by 2 current collectors 25 A, connected through a coupling device.

CODE	AMPERAGE (A)	CONTACT SHOES N°
03.04021.94	2x25 A	4
03.04021.95		5

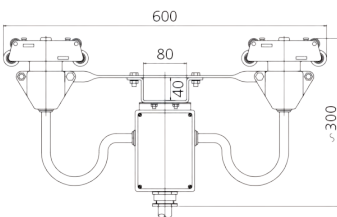

Line type C: continuous conductors - Line type P: pre-mounted conductors

57 Towing arm attachment

FEATURES: Line Type **C/P**

Fixed to the trolley, it allows the coupling with the towing arm.

FOR TROLLEY CODE	"A"	CODE
03.04018.94C - 95C	90 mm.	03.04019.90

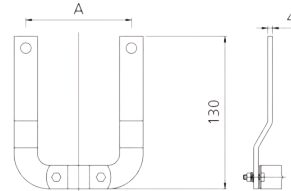

58 Towing arm

FEATURES: Line Type **C/P**

Fixed to the mobile machine it serves to tow the current collector trolley.

FOR TROLLEY CODE	"A"	CODE
03.04018.94C - 95C	140 mm.	03.08026.90
03.04021.94C - 95C	70 mm.	03.08028.90

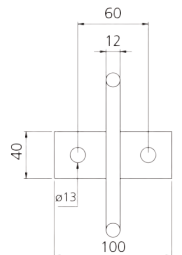

59 Current collector suspension device for transfer guide

FEATURES: Line Type **C/P**

CODE: **03.04028.90**

It serves to support the collector trolley and to facilitate its introduction into lines with transfer guide code 03.04027.90.

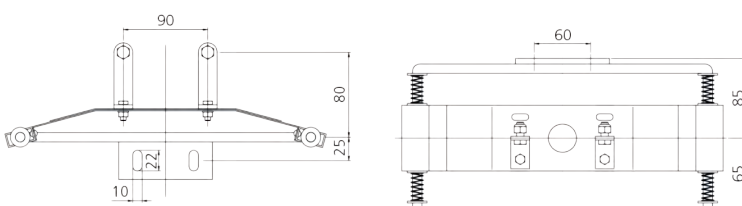

Line type C: continuous conductors - Line type P: pre-mounted conductors

MOUNTING TOOLS

60 Roll holder plate

FEATURES:

Line Type **C**

CODE: **03.04032.90**

Held on a support positioned at the same level of the contact line, it facilitates the unwinding of the conductor from the roll and the introduction into the insulating housing. Extremely light and easy to use.

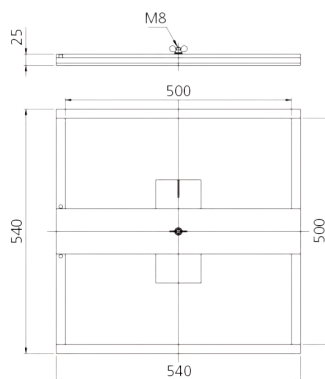

61 Trolley for the insertion of the conductor and for the insertion of the simple strip for closure

FEATURES:

Line Type **C/P**

CODE: **03.04029.90**

Through a tension wire it serves to slide easily the simple strip for closure into the proper shaped seats in the side lower of the insulating housing.

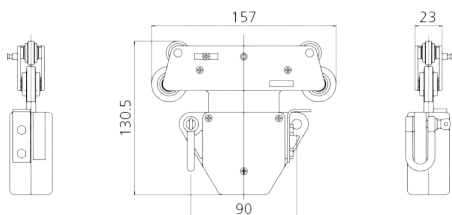

SPARE PARTS

62 Contact conductor

Line Type **C**

CODE	AMPERAGE (A)
03.04001.90	40
03.04001.91	60

63 Insulating housing

Line Type **C**

CODE	LENGTH
03.04000.90	4 mt.
03.04000.91	2 mt.

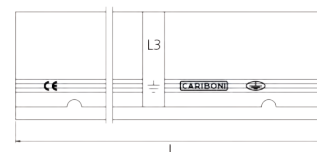
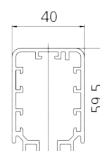

64 Contact shoes

Line Type **C/P**

CODE	AMPERAGE (A)
03.04026.90NH	25

Line type C: continuous conductors - Line type P: pre-mounted conductors

Example of a possible installation

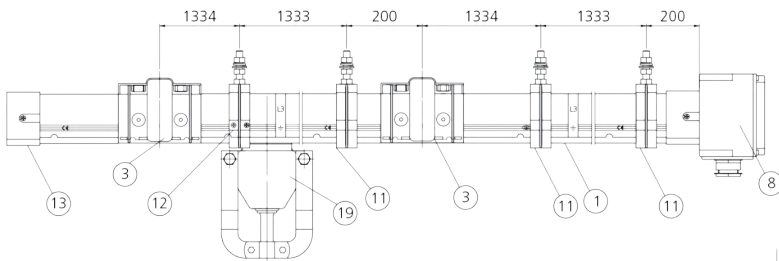

- 1 INSULATING
- 3 JOINT BOX
- 8 FEEDING BOX
- 11 SUPPORT HANGER
- 12 FIXED POINT HANGER
- 13 END CLOSURE BOX
- 19 CABLE COLLECTOR
- 22 TOWING ARM

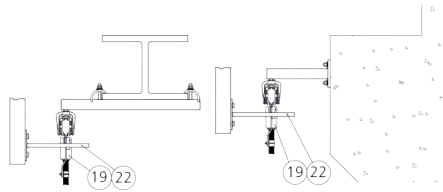

LINE TYPE C: CONTINUOUS CONDUCTORS

FEATURES:

The contact conductors, cut according to the requested length, are inserted inside the housing as soon as it has been installed. In this way an electrical line with continuous conductors has been realised with a considerable reduction of mounting time. This version guarantees also a minimum voltage drop as well as reduced wear and tear on the contact shoes.

Inside the housing, a nib has been foreseen in order to avoid a wrong insertion of the trolley.



LINE TYPE C: INSULATED HOUSING WITH CONTINUOUS CONDUCTORS				
L (m)	Conductors N°	Code		
		70 A	100 A	140 A
4	4	03.03244.91	03.03244.92	03.03244.93
	5	03.03245.91	03.03245.92	03.03245.93
2	4	03.03224.91	03.03224.92	03.03224.93
	5	03.03225.91	03.03225.92	03.03225.93

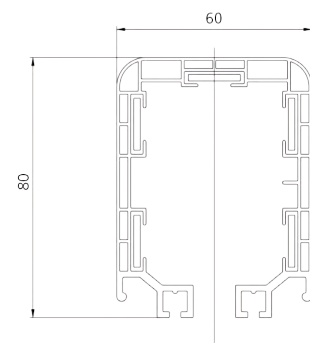

Note: available also au higt temperatures version, suitable up to 65°C ambient. PVC housing in white color.

LINE TYPE P: PRE-MOUNTED CONDUCTORS

FEATURES:

The conductors are already inserted in the housing, inside the relevant seats. In order to facilitate the insertion, the extremities of the conductors have been bent and are ready for the joint with the relevant clamps.

Inside the housing, a nib has been foreseen in order to avoid the wrong insertion of the trolley.



LINE TYPE P: INSULATED HOUSING WITH PRE-MOUNTED CONDUCTORS					
L (m)	Conductors N°	Code			
		70 A	100 A	140 A	200 A
4	4	03.03004.91	03.03004.92	03.03004.93	03.03004.94
	5	03.03005.91	03.03005.92	03.03005.93	03.03005.94
2	4	03.03044.91	03.03044.92	03.03044.93	03.03044.94
	5	03.03045.91	03.03045.92	03.03045.93	03.03045.94

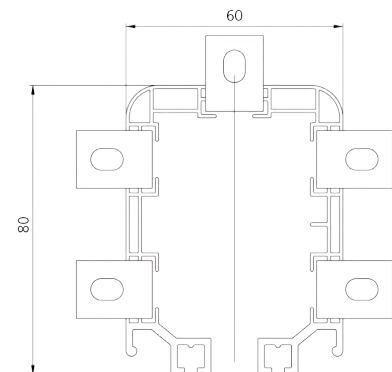

CURVES

It is also possible to supply lines with curves (minimum radius 1250mm 4 conductors). Thanks to the innovative system, the installation of curves is extremely easy and quick and can be applied to both versions of the lines (type C and type P).

Line type C: continuous conductors - Line type P: pre-mounted conductors

All plastic components are made by insulating and self-extinguishing material.

1 Joint box for housing

FEATURES:

Line Type C

CODE: **03.08014.91NS**

It serves to connect two sections of the insulated housing. The release application is very easy and can be carried out without screws and it's equipped with 4 nibs, which guarantee a safe fixing on the housing.

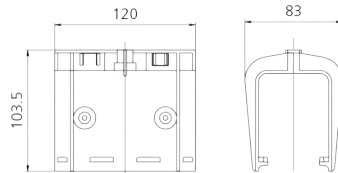

2 Joint box for housing

FEATURES:

Line Type C

CODE: **03.08012.90NN**

It serves to connect two sections of the insulated housing with joined conductors. Used in cases of extension of existing lines or with very long lines, where the conductor cannot be inserted in a single operation. Fixing on the junction made with 2 screws and nuts M6.

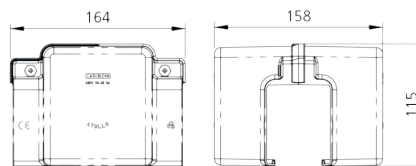

(to be used in case of the junctions are provided conductors)

3 Joint clamp

FEATURES:

Line Type C

CODE: **03.08013.90N**

It serves for the junction of conductors in case of extension of existing lines or of lines particularly long, where the conductors cannot be inserted in a single operation.

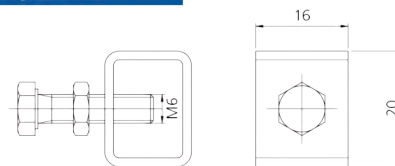

4 Joint box for fixed point

FEATURES:

Line Type C

CODE: **03.08014.93NS**

Applied on the joint point of two sections of housing and fixed to a support bracket in order to ensure the correct distribution of the expansion of the line.

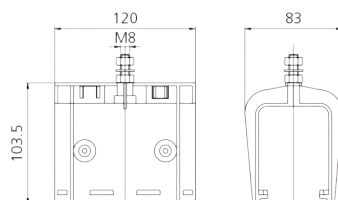

Line type C: continuous conductors - Line type P: pre-mounted conductors

5 Joint box for housing

FEATURES:

Line Type P

CODE: **03.08012.90NM**

It serves to connect two sections of the housing in case of lines type P (pre-mounted conductors). Fixing on the junction made with 2 screws and nuts M6.

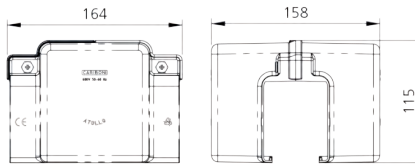

6 Joint clamp

FEATURES:

Line Type P

CODE: **03.08013.90LM**

It is necessary in case of junction of the contact conductors for the lines type P (Pre-mounted conductors). It is mounted on the copper already prepared for the assembling.

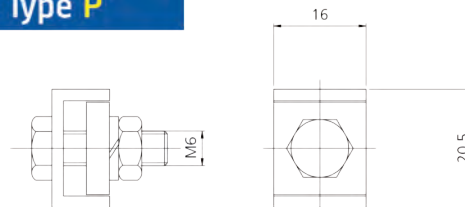

7 End feeder box

FEATURES:

Line Type C

CODE: **03.08016.90**

It is mounted at the end of the line. The removal of the back cover allows an easier installation.

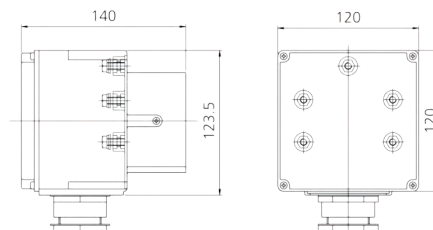

8 Line feeder box

FEATURES:

Line Type C/P

CODE: **03.08017.91N - 92N - 93N**

It can be mounted on each point of the line nearby the junction of 2 housing sections.

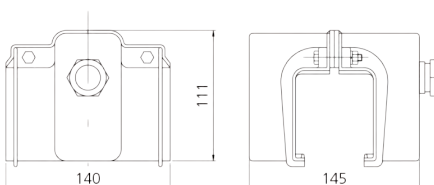

CODE	AMPERAGE (A)
03.08017.91N	70
03.08017.92N	100
03.08017.93N	140



Line type C: continuous conductors - Line type P: pre-mounted conductors

9 Terminal connector for feeder cable

FEATURES: Line Type **C/P**

CODE: **01.02773.90**

Inserted in the joint clamp, it serves to connect the cable (max. section 10 mm²) to the conductor, inside the line feeder box.



10 Line feeder box for line with load 200A

FEATURES: Line Type **P**

CODE: **03.08017.99**

It can be mounted on each point of the line nearby the junction of 2 housing sections.

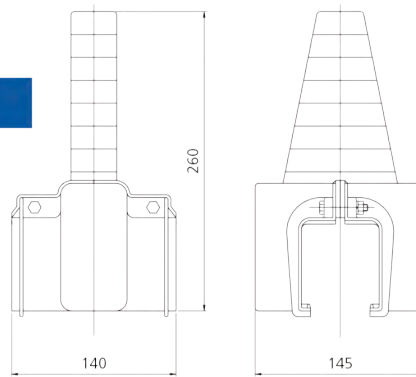

11 Feeder clamps for line with load 200A

FEATURES: Line Type **P**

CODE: **03.08039.90**

It serves to connect the cable (max. section 50 mm²) to the conductor, inside the line feeder box 03.08017.99.

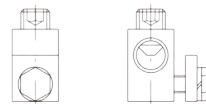

12 Support hanger

FEATURES: Line Type **C/P**

CODE: **03.08018.91N**

Necessary to support the insulating housing and fixed to the support brackets, it permits the creep of the insulating housing due to expansion. The installation distance between 2 contiguous hangers must be max. 2 m.

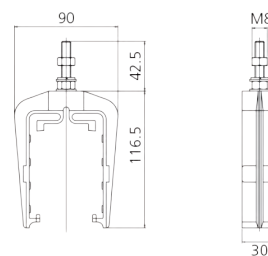

Line type C: continuous conductors - Line type P: pre-mounted conductors

13 Fixed point hanger**FEATURES:****Line Type C/P**CODE: **03.08019.90N**

Locked to the housing through 2 lateral screws it serves to obtain a fixed point in order to ensure an even distribution of the expansion.

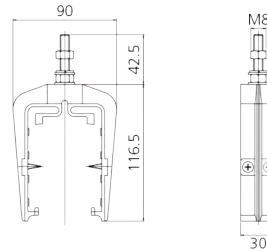
**14** End closure box**FEATURES:****Line Type C/P**CODE: **03.08023.90**

Fixed to the insulating housing, it serves to close the end of the line.

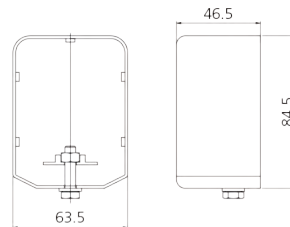
**15** Simple strip for closure**FEATURES:****Line Type C/P**CODE: **03.08007.90N**

Two flexible sealing strips, passed through the side grooves of the housing, ensure an additional protection of the insulating housing of the contact line from IP 13 to IP 23.

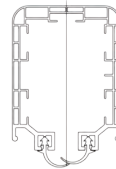
**16** Expansion joint**FEATURES:****Line Type C**CODICE: **03.03029.90**

Used in case of lines particularly long to compensate the insulating housing expansion. Installed between 2 fixed points, it is necessary to foresee a further support bracket.

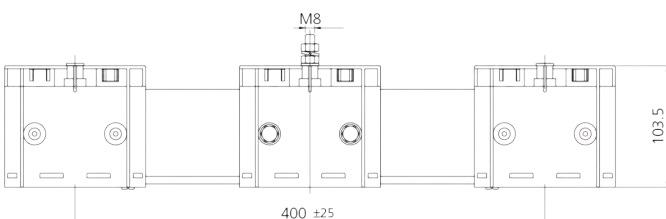

Contact our main office for a budget quote:

Munck Cranes AS Bergen, Norway:

Telephone: 55 59 80 00
Telefax: 55 59 80 40
Email: firmapost@munck-cranes.no
Address: Kokstadveien 30
5257 Kokstad
Norway

Munck Cranes AB Sweden:

Telephone: +46 13-31 49 00
Telefax: +46 13-14 89 00
Email: kjell.petterson@munck-cranes.se
Address: Hertig Karlsgatan 2
582 21 Linköping

Munck Kraner A/S Denmark:

Sentralbord: +45 7022 4585
Telefax: +45 8691 1984
Email: info@munck-kraner.dk
Address: Industrivej 14
DK - 8920 Randers NV

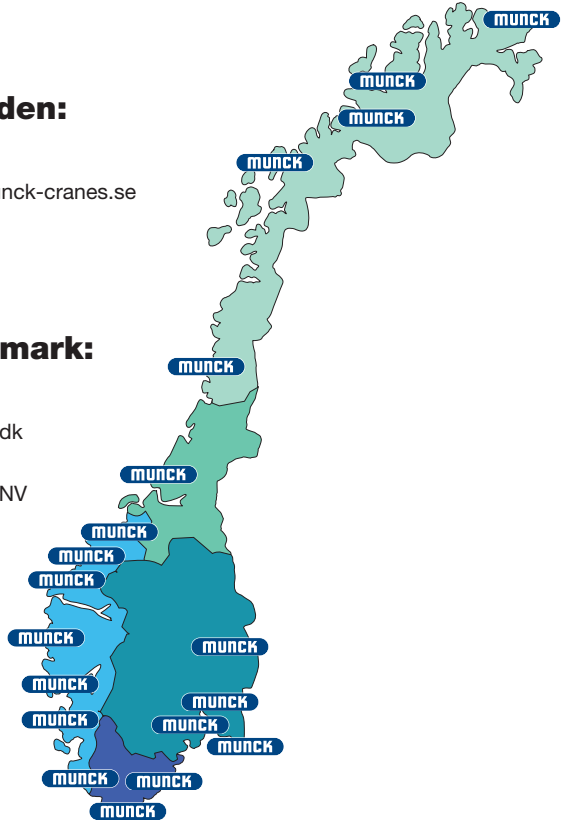

**A certified enterprise
of competence**

Munck Cranes AS a certified enterprise of competence:

- Management System certificate acc. to the requirements of NS-EN ISO 9001:2008 - Certificate no: 040
- Enterprise of Competence for control of work equipment - Certificate no: SV-002
- Enterprise of Competence for safety training for use of work equipment - Certificate no: SO-014

Address: Kokstadveien 30,
NO-5257 Kokstad, Norway

E-mail: firmapost@munck-cranes.no
Web: www.munck-cranes.no

Phone/Telefon: +47 55 59 80 00
Telefax: +47 55 59 80 40